



SPARK



OWNER'S MANUAL

**Read and understand this entire manual before
allowing child to use this product!**
For assistance contact Razor. DO NOT RETURN TO STORE.

Item Number:
Black 13010400
Red 13010460
Blue 13010440

CONTENTS

Safety Warnings	1-2	Spark Scooter Parts List	5
Before you begin	2	Safety Tips	6
Set up and usage instructions	3-4	Warranty	6
Check Before Riding.....	4-5		

SAFETY WARNINGS

⚠ AN IMPORTANT MESSAGE TO PARENTS: This manual contains important information. For your child's safety, it is your responsibility to review this information with your child and make sure that your child understands all warnings, cautions, instructions and safety topics. Razor recommends that you periodically review and reinforce the information in this manual with younger riders and that you are required to inspect and maintain your child's scooter to insure their safety.

⚠ GENERAL WARNING: Scooter riding can be a hazardous activity. Scooters can and are intended to move and it is therefore possible to get into dangerous situations and/or lose control and/or fall. If such things occur you can be seriously injured or die. **LIKE ANY OTHER MOVING PRODUCT, USING A SCOOTER CAN BE A DANGEROUS ACTIVITY AND MAY RESULT IN INJURY OR DEATH EVEN WHEN USED WITH PROPER SAFETY PRECAUTIONS USE AT YOUR OWN RISK AND USE COMMON SENSE.**

- Always wear safety equipment such as helmet. Knee pads, elbow pads, long pants and sleeves are recommended. Always wear a helmet when riding your scooter and keep the chinstrap securely buckled.
- Always wear shoes.
- Ride on smooth, paved surfaces away from motor vehicles.
- Avoid sharp bumps, drainage grates, and sudden surface changes that may cause scooter to suddenly stop.
- Avoid streets and surfaces with water, sand, gravel, dirt, leaves, and other debris. Wet weather impairs traction, braking, and visibility.
- Do not ride at night.
- Brake and cartridge will get hot from continuous use. Do not touch after using.
- Avoid excessive speed associated with downhill rides.
- Adults must assist children in the initial adjustment procedures to unfold scooter, adjust handlebar and steering to height, and finally to fold scooter.
- Obey all local traffic and scootering laws and regulations.
- Watch out for pedestrians.
- Do not exceed 143 pounds (65 kilograms) total weight on the Spark scooter.
- Rider weight does not necessarily mean a child's size is appropriate to fit or maintain control of the scooter.
- A parent's decision to allow his or her child to ride this product should be based on the child's maturity, skill and ability.

⚠ ADDITIONAL SPARK SCOOTER WARNINGS:

PARENTS and RIDERS: Make sure riders understand that sparks can start a fire, and the Spark scooter must be used with care to avoid accidentally igniting particularly flammable things.

Toys that make sparks have been around for years, but as with everything else, safety is important and parents and riders must consider:

- Any scooter should be ridden only on dry, solid surfaces. This helps assure traction, braking and control when riding
- When riding a Spark scooter, the importance of dry and solid surfaces also applies to assure that nothing is on the ground that might accidentally catch fire based upon even brief exposure to a spark.
- Don't ride in or around dry leaves, grass, weeds or paper.
- Don't ride around chemicals, gasoline or fuels, and stay away from places like gas stations.
- Your Spark scooter is designed to emit localized, sparks when the Spark Bar on a moving scooter is put in contact with hardened outdoor ground surfaces like concrete or asphalt, and it should NEVER be used to try to start a fire
- Don't ever allow hands, faces or eyes to be on the ground near the sparks made by a Spark scooter as it passes by because actual sparks are HOT and could cause injury if touched.
- Ride your Spark scooter on clean, dry, hardened outdoor surfaces.
- Observe all other scooter safety recommendations as provided elsewhere in this manual.
- Keep sparks away from clothing or other flammable materials.
- **CLOSE ADULT SUPERVISION** is recommended. Do not allow children under 8 to ride this product

SAFETY WARNINGS

PROPER RIDING ATTIRE

Always ensure child is wearing proper protective equipment such as an approved safety helmet. A helmet may be legally required by local law or regulation in your area. A child should always wear shoes, never ride barefooted or in sandals, and keep shoelaces tied and out of the way of the wheels.

FAILURE TO USE COMMON SENSE AND HEED THE PRECEDING WARNINGS FURTHER INCREASES RISK OF SERIOUS INJURY. USE AT YOUR OWN RISK AND WITH APPROPRIATE AND SERIOUS ATTENTION TO SAFE OPERATION. USE CAUTION.

! WARNING: ALWAYS INSPECT SCOOTER PRIOR TO RIDING. Properly inspecting and maintaining your scooter can reduce the risk of injury. Always inspect your scooter before riding and regularly maintain it.

! WARNING: CHECK LOCAL LAWS REGARDING SCOOTER USE. Check local laws and regulations to see where and how you may use your Razor scooter legally. In many states and local areas scooter riders are required BY LAW to wear a helmet. Check local laws and regulations regarding laws governing helmet use and scooter operation in your area.

BEFORE YOU BEGIN

Remove contents from box. Remove the packing material used to protect the components from damage during shipping. Inspect the contents of the box for scratches in the paint, dents that may have occurred during shipping. Because your scooter is assembled and packed at the factory, there should not be any problems, even if the box has a few scars or dents.

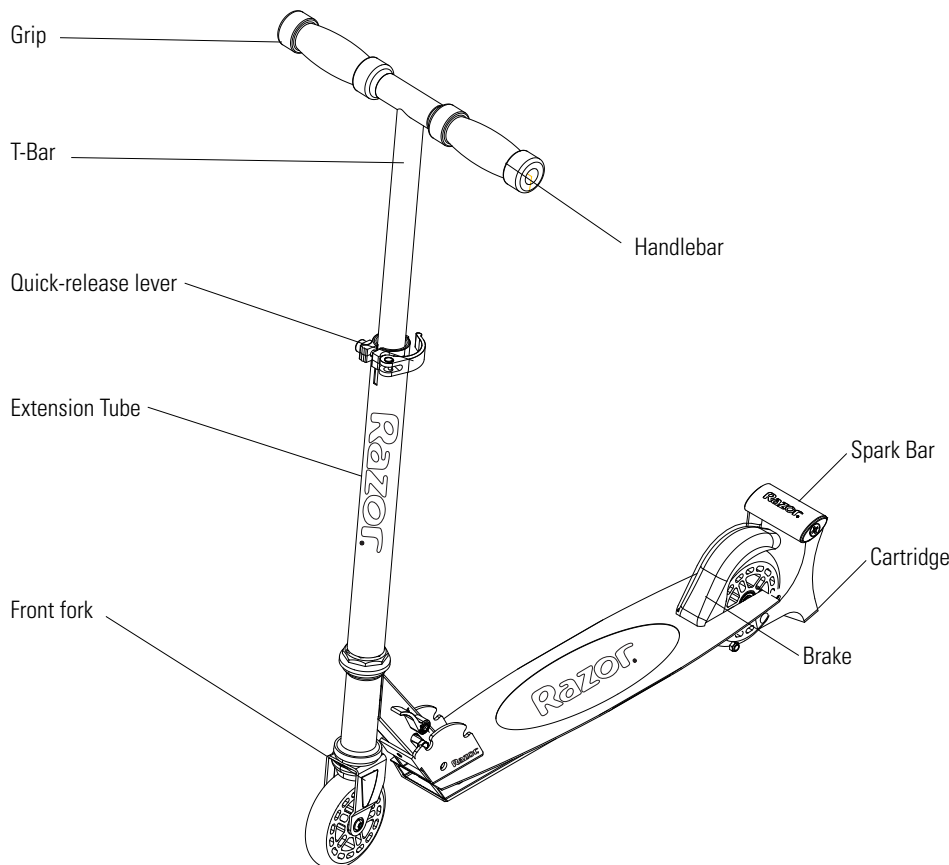

! WARNING: DO NOT USE NON-RAZOR PARTS WITH YOUR SCOOTER. Razor scooters have been built to certain Razor design specifications. The original equipment supplied at the time of sale was selected on the basis of its compatibility with the frame, fork and all other parts. Certain aftermarket parts may or may not be compatible and will void your warranty.

Need Help? Visit our web site for replacement parts, product support and a list of authorized service centers at www.razor.com or call toll-free at 866-467-2967 Monday - Friday 8:00 AM - 5:00 PM Pacific Time.

SET UP AND USAGE INSTRUCTIONS

□ Unfolding the scooter for first time use.

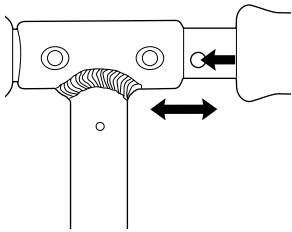

1 Insert and secure the left and right handlebars by pressing the spring-loaded buttons and inserting them into the T-tube.

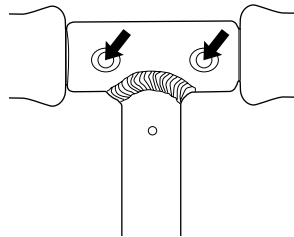

2 Make certain **BOTH** handlebars are properly locked onto the T-bar.

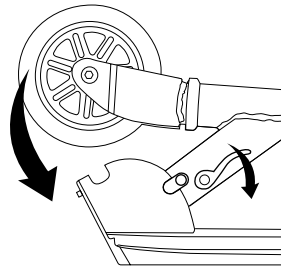

3 To release the folding mechanism, put one foot on the deck plate and push joint release lever down. Raise handlebars up until securely locked in the upright position.

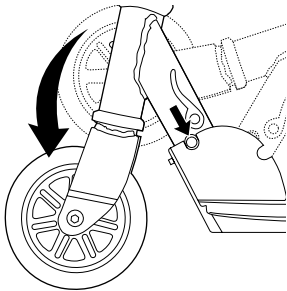

Note: The joint lever is spring-loaded and will automatically lock in the upright position when fully upright.

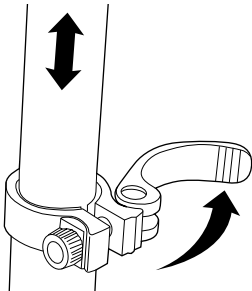

4 Depress the spring loaded button on the T-bar and insert into the extension tube. Turn the handlebar until the button aligns with the hole on the extension tube and locks into place. To adjust the height of the handlebars, open the quick-release lever and slide the T-bar to the desired position and resecure the quick release lever to lock into place. If the T-bar is raised to the maximum height, depress the push button located directly below the quick release lever to lower the T-bar.

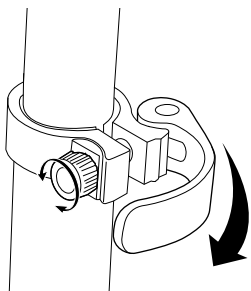

Note: The tension of the quick-release lever can be adjusted by tightening or loosening the allen bolt. Be careful not to over-tighten. You should always be able to open and close the quick-release lever by hand and the T-bar should slide freely with the quick-release open.

⚠ WARNING: Failure to properly secure the spring-loaded buttons may cause the handlebars to dislodge while riding and may cause you to lose control and/or fall. When properly secured, the handlebars will not rotate and/or move sideways. Note: When properly secured, the spring-loaded buttons will be clearly visible through the holes on the T-tube.

⚠ WARNING: Keep your fingers clear of the pivoting mechanism when folding or unfolding the scooter. Make sure others are standing clear.

⚠ WARNING: Failure to properly secure the quick-release lever may cause the T-bar to slide up or down while riding which may cause you to lose control and fall.

SET UP AND USAGE INSTRUCTIONS

□ Replacing the spark cartridge

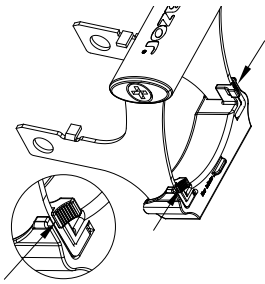

1 Using your thumbs, press tabs on both sides of the cartridge to release from the bracket. Slide cartridge away from you and remove from bracket

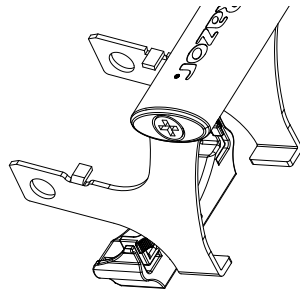

2 Place a new cartridge in back of the bracket, making sure to align the slots on the cartridge with the two legs of the bracket.

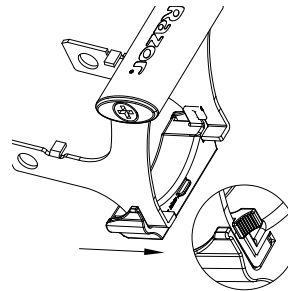

3 Insert the legs into the slots until you hear a click and the thumb tabs are locked in position.

□ Using the spark bar

When riding, place ball of foot on the spark bar and gradually apply pressure. Only use enough pressure to cause sparking action.

CHECK BEFORE RIDING

□ Collar Clamp

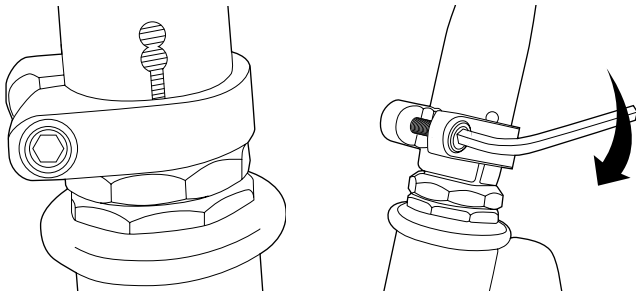

Using a 5mm allen key, check that the collar clamp bolt is tightened securely. This item is tightened and quality inspected at the factory, but there is a slight chance that the effects of shipping or handling may have caused this bolt to become loose.

□ Deck Plate/Steering Column Adjusting Screw(s)

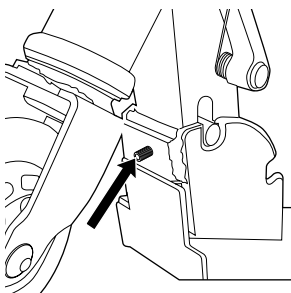

Using a 3mm allen wrench and with the scooter in the upright and locked position, adjust the set screw at the baseboard until there is no free-play between the baseboard and the steering column. Be careful not to over-tighten this screw as it needs only be snug against the steering column. Verify the adjustment by releasing the steering column from the locked position and folding the scooter. The locking lever should not bind and the folding movement should be smooth. The spring-loaded mechanism should automatically lock and be fully seated in the upright position.

⚠ WARNING: Do not attempt to replace cartridge while it is hot, such as immediately after riding. Handle only when cool.

⚠ WARNING: Applying too much pressure on the spark bar may cause loss of control.

NOTE: Using any other part of the foot or full foot may activate the brake and prevent sparking action.

NOTE: Sparks and spark cartridge life will vary based on the amount of pressure applied to the spark bar, the length of time pressure is applied and the smoothness of the riding surface.

Need Help? Visit our web site for replacement parts, product support and a list of authorized service centers at www.razor.com or call toll-free at 866-467-2967 Monday - Friday 8:00 AM - 5:00 PM Pacific Time.

CHECK BEFORE RIDING

❑ Wheels and Bearings

Under normal circumstances and conditions, Razor wheels and bearings are maintenance free. Nonetheless, it is the responsibility of the owner or guardian to periodically inspect the wheels for wear and tear, the axle for proper tightness, and bearings for side-to-side play and loose parts. When a wheel or wheel bearing develops play, this is an indication of excess wear and replacement is necessary. Replace immediately with only genuine Razor wheels. Wheels other than genuine Razor wheels may not be compatible with your Razor scooter. The use of anything other than genuine Razor replacement parts may affect your safety and will void your warranty.

❑ Cleaning Your Scooter

Wipe with a damp cloth to remove dirt and dust.

Do not use industrial cleaners or solvents as they may damage the surfaces. Do not use alcohol, alcohol-based or ammonia-based cleaners as they may damage or dissolve the plastic components or soften the decals or decal adhesive.

⚠ WARNING: Wheelies and other stunt-type riding reduces your ability to maneuver and control the scooter. Take the necessary precautions, such as wearing appropriate protective gear and practice in a area safe for stunt riding and free from obstructions.

NOTE: Worn wheels, bearings and spark cartridges are considered normal wear-and-tear and are not covered by the Razor Warranty.

SPARK SCOOTER PARTS LIST

Keep your Spark scooter running for years with genuine Razor parts. Visit our web site or e-mail us for more information on spare part availability. (Specifications subject to change without notice.)

- | | |
|------------------------|----------------------------|
| 1. Grip | 8. Fork |
| 2. Handlebar | 9. Axle Bolt |
| 3. T-Bar | 10. 98mm Wheel |
| 4. Quick-Release Lever | 11. Folding Mechanism |
| 5. Extension Tube | 12. Bracket with Cartridge |
| 6. Collar Clamp | 13. Brake |
| 7. Headset | |

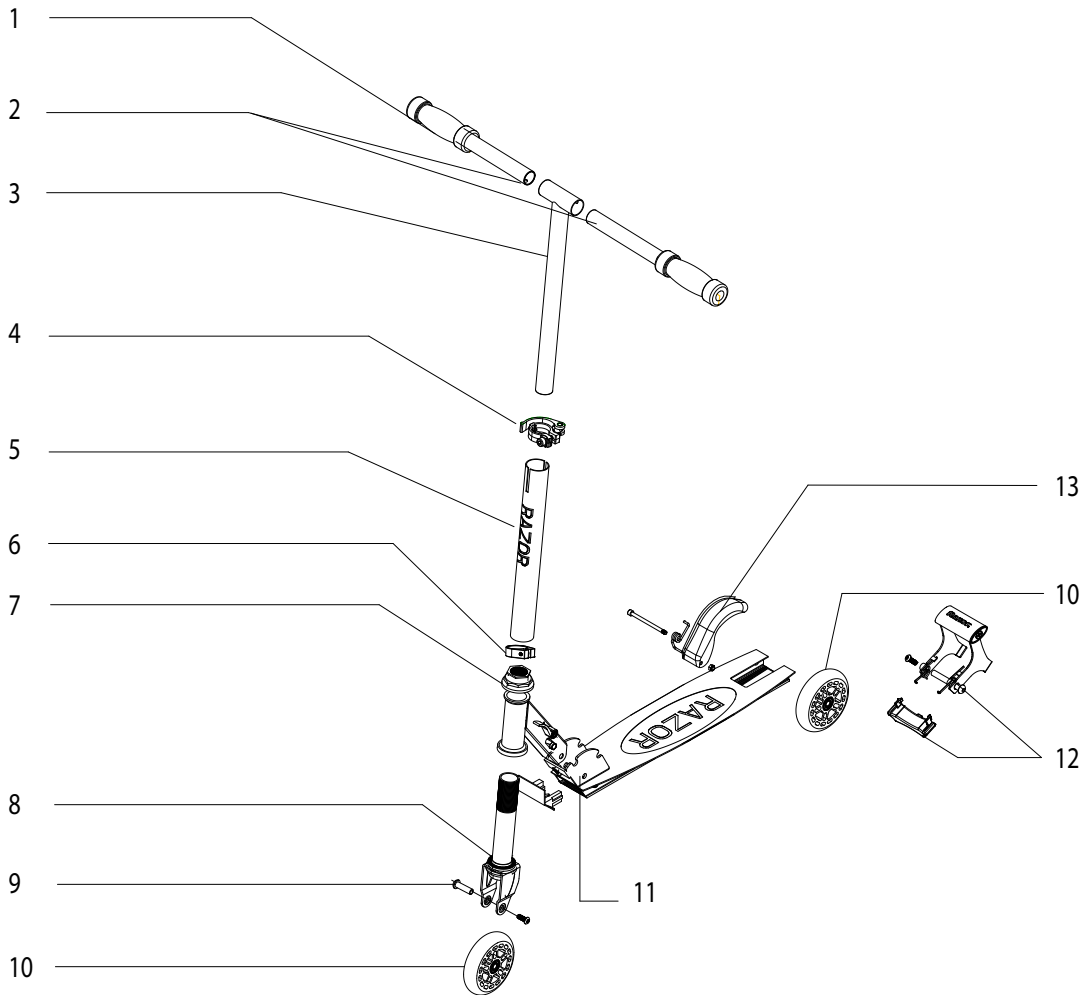

SAFETY REMINDERS

PRE-RIDE CHECKLIST



Loose Parts

Check and secure all fasteners before every ride. Make sure the collar clamp, T-bar, quick release lever and handlebar spring buttons are locked properly in place before riding.



Replacement Parts

Replace worn or broken parts immediately. Call 1-866-GO-RAZOR for parts.



Safety Gear

Always wear proper protective equipment such as an approved safety helmet. Elbow pads and kneepads are recommended. Always wear shoes (lace-up with rubber soles), never ride barefooted or in sandals and keep shoelaces tied and out of the way of the wheels.



Be Careful!

You will see people on TV and maybe even people you know doing tricks and stunts. These are people who have been practicing on scooters for a very long time. Don't try something until you are ready. Avoid steep inclines and don't ride too fast — you can lose control and fall. Skateboard parks are not designed for scooters. Never ride in traffic or on the street and watch your surroundings for pedestrians, bikers, boarders and skaters.

Maintain a hold on the handlebars at all times.

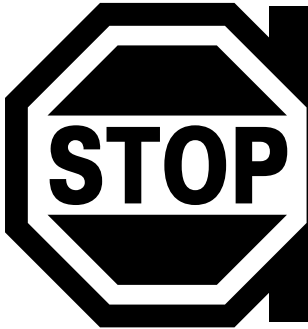

DO NOT RETURN TO STORE
Failure to follow these instructions may damage
your product and void your warranty.

WARRANTY

Razor Limited Warranty

The manufacturer warrants this product to be free of manufacturing defects for a period of 6 months from date of purchase. This Limited Warranty does not cover normal wear and tear, wheels, spark cartridges or any damage, failure or loss caused by improper maintenance or storage.

This Limited Warranty will be void if the product is ever

- used in a manner other than for recreation;
- modified in any way;
- rented.

The manufacturer is not liable for incidental or consequential loss or damage due directly or indirectly to the use of this product.

Razor does not offer an extended warranty. If you have purchased an extended warranty, it must be honored by the store at which it was purchased.

For your records, save your original sales receipt with this manual.

Item Number:

Black 13010400
Red 13010460
Blue 13010440

Need Help? Visit our web site for replacement parts, product support and a list of authorized service centers at www.razor.com or call toll-free at 866-467-2967 Monday - Friday 8:00 AM - 5:00 PM Pacific Time.

Patent Pending
Printed in China for:
Razor USA LLC
PO Box 3610
Cerritos, CA 90703
Copyright © 2003-2009 Razor USA, LLC. All rights reserved. RAZOR and the Razor Logo Design are among the registered trademarks of Razor USA LLC in the United States and/or select foreign countries. Spark is a trademark of Razor USA LLC.